

container

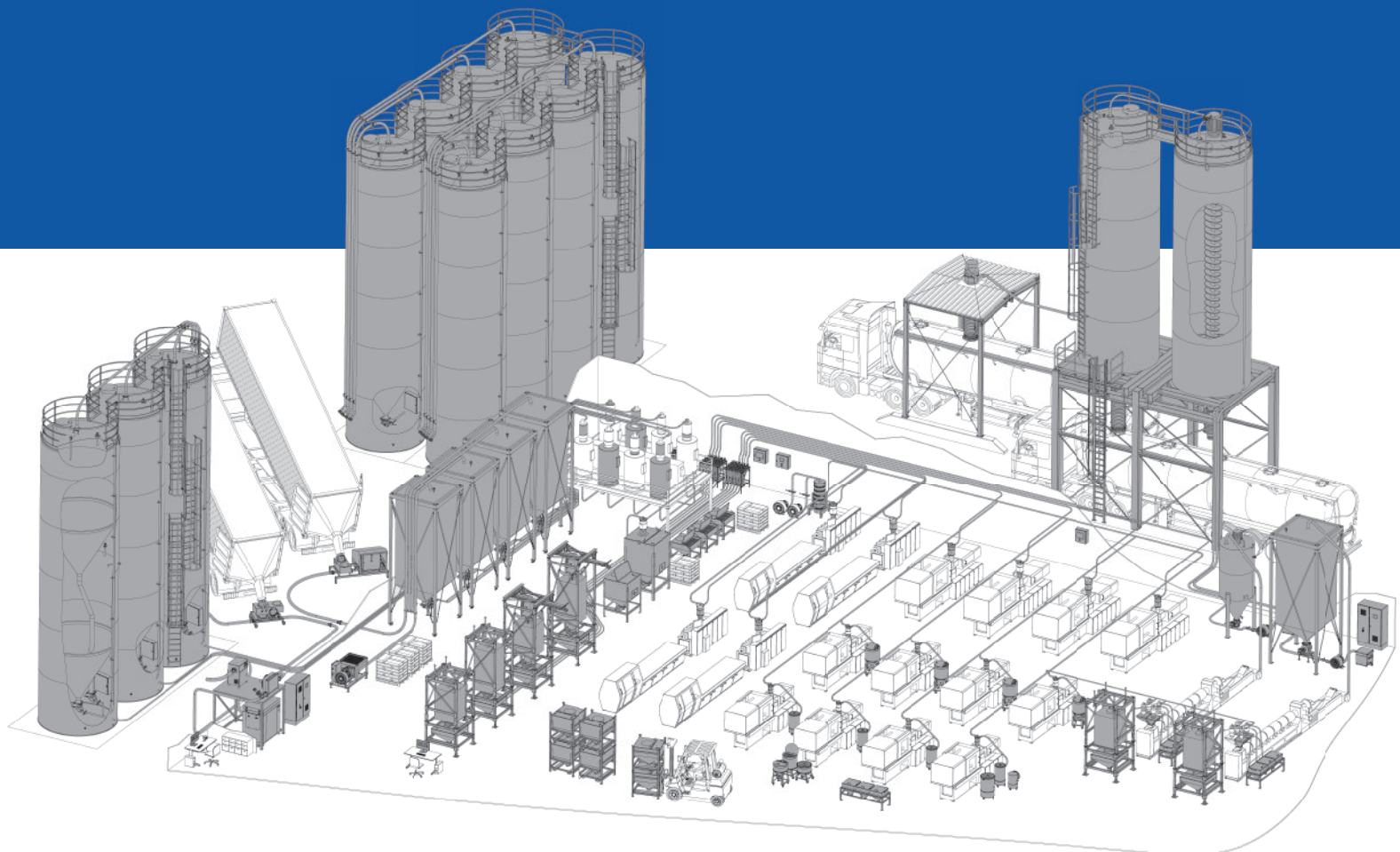

Container

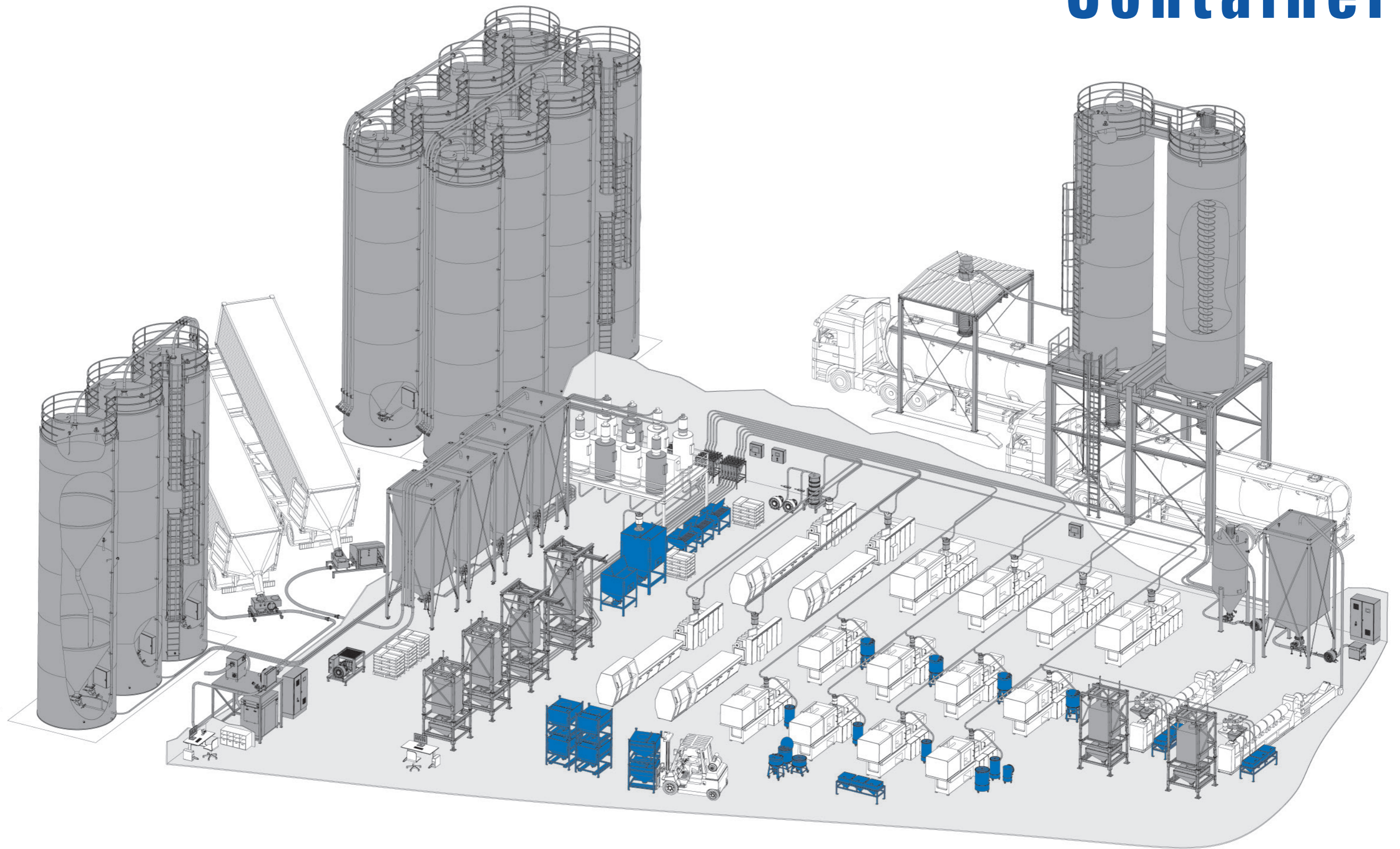

roller container CR.A1

roller container CR.A1

- stainless steel
- with transparent plastic cover
- 4 lockable guide rollers
- sideways guide pipe for single-walled suction probes (max. Ø50)



	volume	Ø	H	α
CR.A1.0060.0400.1.CR	60 l	400	735	90°
CR.A1.0120.0450.1.CR	120 l	450	995	90°
CR.A1.0240.0630.1.CR	240 l	630	1040	90°

foldaway cover

- stainless steel
- 2 openings for suction probes
- for 240 l container



CR.Z.DECKEL.630.9	Ø
	630

cover for vacuum conveyor

- stainless steel
- removable (2 handles)
- Ø according to customer's specification



CR.Z.DECKEL.400	Ø
	400
CR.Z.DECKEL.450	450
CR.Z.DECKEL.630	630

suction probes single-walled

- stainless steel
- insertable in sideways guide pipe



	Ø	volume container	length
SGL.1A.038.0500.CR	38	60/120 l	530
SGL.1A.040.0500.CR	40	60/120 l	530
SGL.1A.045.0500.CR	45	60/120 l	530
SGL.1A.050.0500.CR	50	60/120 l	530
SGL.1A.030.0800.CR	30	240 l	820
SGL.1A.038.0800.CR	38	240 l	820
SGL.1A.040.0800.CR	40	240 l	820
SGL.1A.045.0800.CR	45	240 l	820
SGL.1A.050.0800.CR	50	240 l	820

clip

- for material card

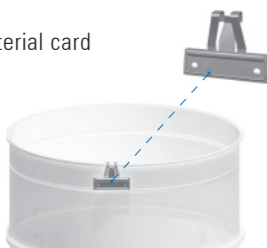

CR.Z.CLIP	Ø
	630

grid

- stainless steel
- for 240 l container



CR.Z.ROST.630.01.CR	Ø
	630

samples

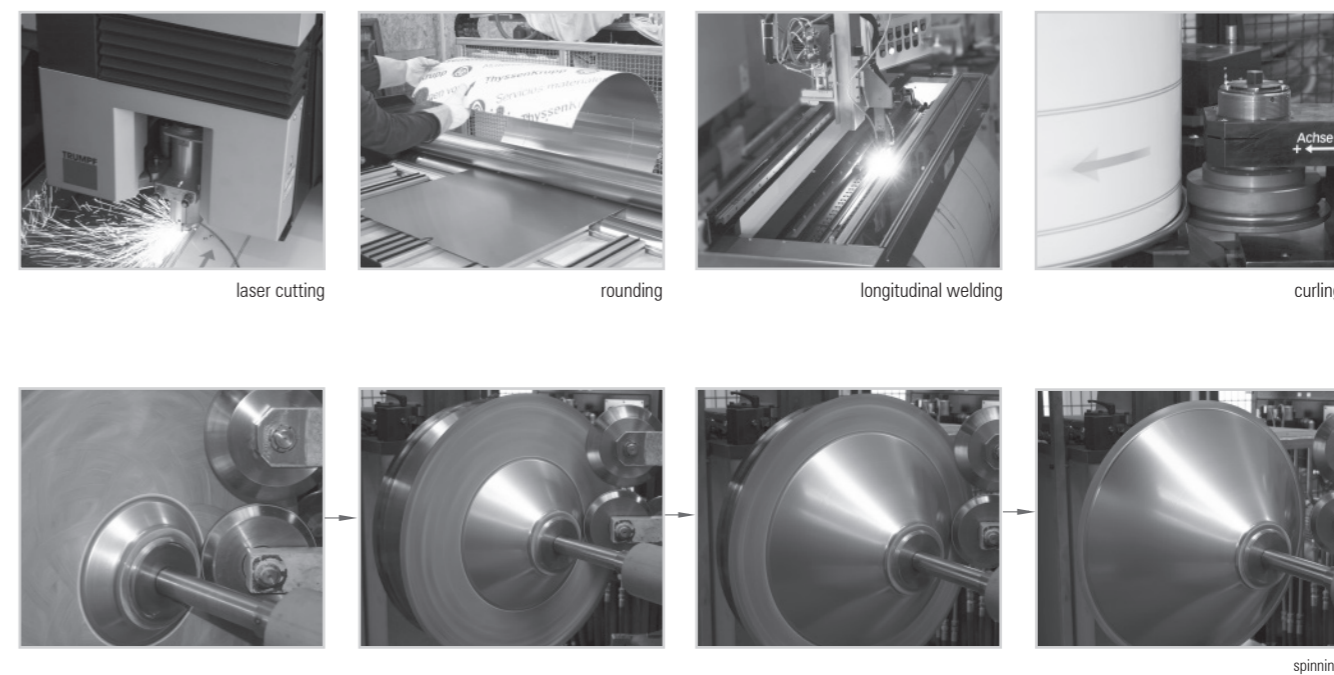

roller container CR.B1 + CR.B2

roller container CR.B1

- stainless steel
- 4 steel feet (RAL9005)
- 2 fixed rollers and 2 lockable guide rollers



NEW

	volume	Ø	H	h	α
CR.B1.0120.0630.1.CR	120 l	630	750	170	90°
CR.B1.0215.0630.1.CR	215 l	630	1030	170	90°
CR.B1.0300.0950.1.CR	300 l	950	950	170	90°
CR.B1.0400.0950.1.CR	400 l	950	1100	170	90°
CR.B1.0500.0950.1.CR	500 l	950	1200	170	90°

*Ø950 available from March 2019

roller container CR.B2

- stainless steel
- 4 steel feet (RAL9005)
- 2 fixed rollers and 2 lockable guide rollers

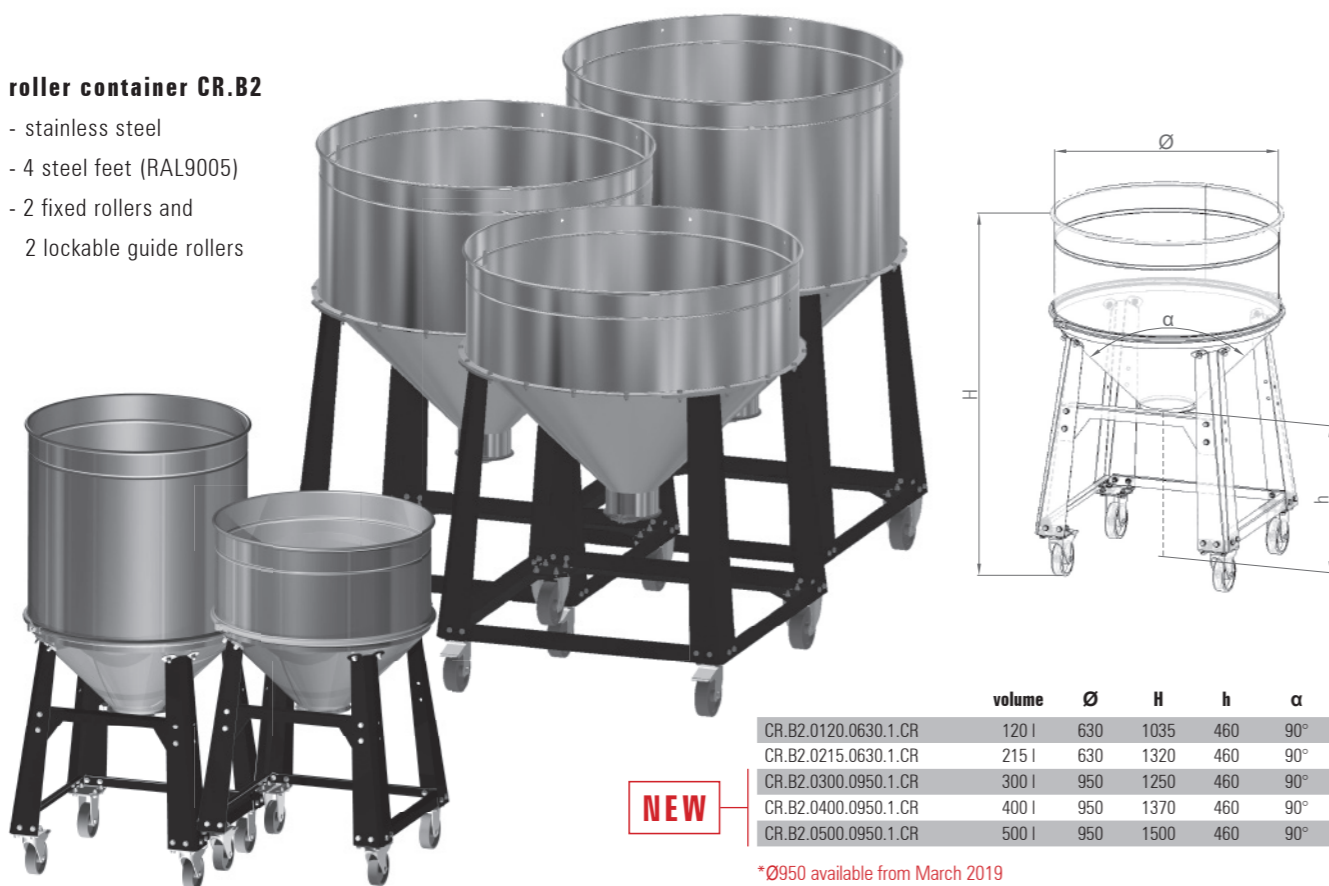

NEW

	volume	Ø	H	h	α
CR.B2.0120.0630.1.CR	120 l	630	1035	460	90°
CR.B2.0215.0630.1.CR	215 l	630	1320	460	90°
CR.B2.0300.0950.1.CR	300 l	950	1250	460	90°
CR.B2.0400.0950.1.CR	400 l	950	1370	460	90°
CR.B2.0500.0950.1.CR	500 l	950	1500	460	90°

*Ø950 available from March 2019

accessories Ø630

cover

- plastics



	Ø	colour
CR.Z.DECKEL.630.1	630	transparent
CR.Z.DECKEL.630.2	630	black

foldaway cover Ø630

- stainless steel
- 2 openings for suction probes



	Ø
CR.Z.DECKEL.630.9	630

cover for vacuum conveyor

- stainless steel
- removable (2 handles)
- Ø according to customer's specification



	Ø
CR.Z.DECKEL.630	630

grid

- stainless steel



	Ø
CR.Z.ROST.630.01.CR	630

suction probes double-walled

- stainless steel
- insertable from above



	Ø	length
SGL.2A.038.1000.CR	38	1000
SGL.2A.040.1000.CR	40	1000
SGL.2A.045.1000.CR	45	1000
SGL.2A.050.1000.CR	50	1000
SGL.2A.060.1000.CR	60	1000
SGL.2A.065.1000.CR	65	1000
SGL.2A.070.1000.CR	70	1000
SGL.2A.076.1000.CR	76	1000

accessories Ø950

foldaway cover Ø950

- stainless steel

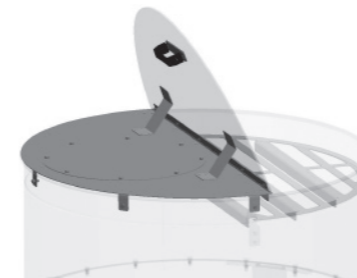

	Ø
CR.Z.DECKEL.950.9	950

adapter plate for vacuum conveyor

- stainless steel
- Ø according to customer's specification

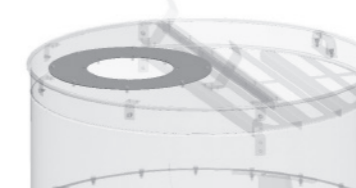

	Ø
CE.Z.ADAPT.SFG.CR	

grid

- stainless steel

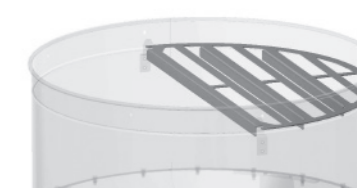

	Ø
CR.Z.ROST.950.01.CR	950

accessories Ø630 + Ø950

clip

- for material card



CR.Z.CLIP

suction box

- stainless steel
- 1-way or 2-way
- Ø38 - 60



ASK.CR.1 suction box 1-way
ASK.CR.2 suction box 2-way

suction probes for suction box

- Ø38 - 60



	Ø	length
SGL.1A.038.0300.CR	38	300
SGL.1A.040.0300.CR	40	300
SGL.1A.045.0300.CR	45	300
SGL.1A.050.0300.CR	50	300
SGL.1A.060.0300.CR	60	300

slide valve

- stainless steel

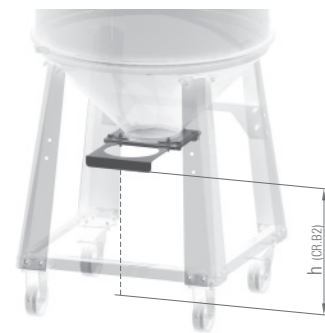

CR.Z.SCHIEBER.01.CR Ø 150 h 430

butterfly valve ND150

- stainless steel
- with gasket

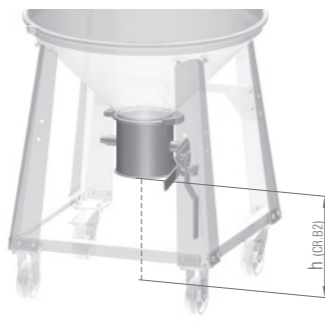

CR.Z.DK.150.CR Ø 150 h 310



samples



container CE.A1

container CE.A1

- aluminium / stainless steel
- 4 steel feet (RAL9005)
- height adjustable
- foldaway cover with stop
- support for grid
- opening for vacuum conveyor on the roof (closed by plate)
- opening for level indicator in the cone (closed by plate)

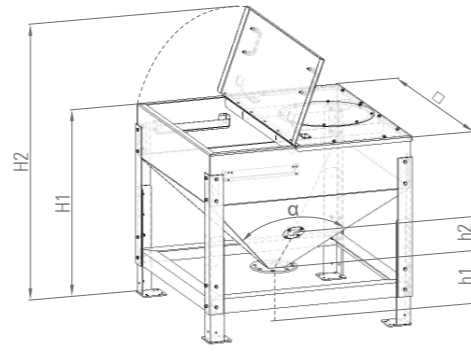

aluminium	stainless steel	volume	□	H1	H2	h1*	h2	α
CE.A1.0300.1000.0800.90.02.AL	CE.A1.0300.1000.0800.90.01.CR	300 l	800 x 1000	890	1325	200	270	90°
CE.A1.0400.1000.1000.90.02.AL	CE.A1.0400.1000.1000.90.01.CR	400 l	1000	920	1355	200	322	90°
CE.A1.0500.1000.1000.90.02.AL	CE.A1.0500.1000.1000.90.01.CR	500 l	1000	1005	1440	200	322	90°
CE.A1.0500.1200.1200.90.02.AL	CE.A1.0500.1200.1200.90.01.CR	500 l	1200	960	1495	200	392	90°
CE.A1.0750.1200.1200.90.02.AL	CE.A1.0750.1200.1200.90.01.CR	750 l	1200	1110	1645	200	392	90°

*adjustable for height 200, 300 oder 400 mm

container CE.A1

- aluminium / stainless steel
- 4 steel feet (RAL9005)
- foldaway cover with stop
- support for grid
- opening for vacuum conveyor on the roof (closed by plate)
- opening for MAX and MIN level indicator (closed by plate)
- inspection opening (450 x 300 mm) with sight glass

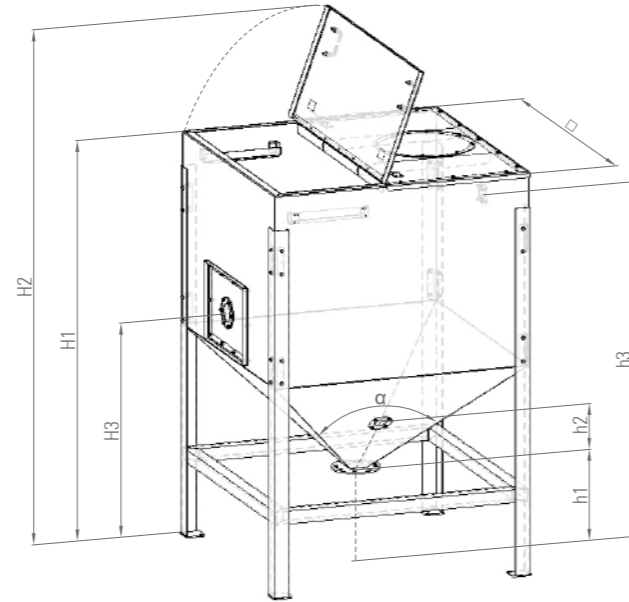
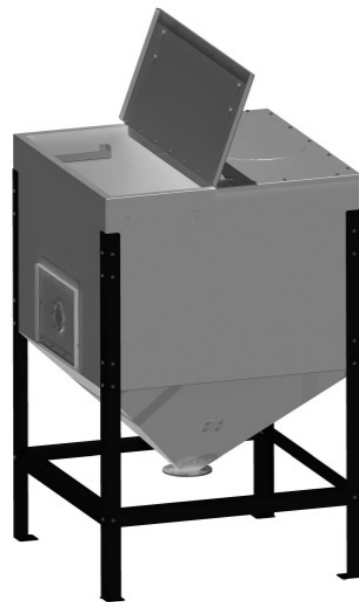

aluminium	stainless steel	volume	□	H1	H2	H3	h1	h2	h3	α
CE.A1.1000.1200.1200.90.02.AL	CE.A1.1000.1200.1200.90.01.CR	1000 l	1200	1510	2045	1170	400	392	1255	90°
CE.A1.1500.1200.1200.90.02.AL	CE.A1.1500.1200.1200.90.01.CR	1500 l	1200	1860	2395	1170	400	392	1605	90°
CE.A1.2000.1200.1200.90.02.AL	CE.A1.2000.1200.1200.90.01.CR	2000 l	1200	2210	2745	1170	400	392	1955	90°
CE.A1.2000.1500.1500.90.02.AL	CE.A1.2000.1500.1500.90.01.CR	2000 l	1500	1800	2335	1320	400	498	1445	90°
CE.A1.2500.1500.1500.90.02.AL	CE.A1.2500.1500.1500.90.01.CR	2500 l	1500	2020	2555	1320	400	498	1665	90°
CE.A1.3000.1500.1500.90.02.AL	CE.A1.3000.1500.1500.90.01.CR	3000 l	1500	2270	2805	1320	400	498	1915	90°
CE.A1.4000.1500.1500.90.02.AL	CE.A1.4000.1500.1500.90.01.CR	4000 l	1500	2720	3255	1320	400	498	2365	90°
CE.A1.4800.1500.1500.90.02.AL	CE.A1.4800.1500.1500.90.01.CR	4800 l	1500	3070	3605	1320	400	498	2715	90°

grid

- stainless steel



	□ container
CE.Z.ROST.0800.CR	800 x 1000
CE.Z.ROST.1000.CR	1000
CE.Z.ROST.1200.CR	1200
CE.Z.ROST.1500.CR	1500

pneumatic spring for cover

- fixing point at the sides of the cover

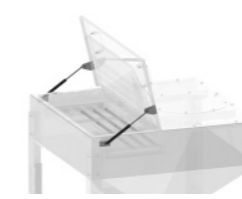

	□ container
CE.Z.DACH.GASDRUCKF.0800	800 x 1000
CE.Z.DACH.GASDRUCKF.1000	1000
CE.Z.DACH.GASDRUCKF.1200	1200
CE.Z.DACH.GASDRUCKF.1500	1500

adapter plate for vacuum conveyor

- stainless steel

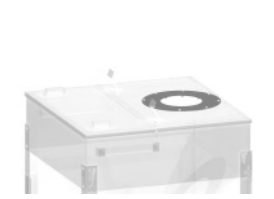

	connection dimensions*
CE.Z.ADAPT.SFG.DIG.280.CR	Di 250; BCD 280; 6 x M6
CE.Z.ADAPT.SFG.FER.225.CR	Di 202; BCD 225; 8 x M6
CE.Z.ADAPT.SFG.FER.330.CR	Di 311.5; BCD 330; 8 x M6
CE.Z.ADAPT.SFG.KOC.268.CR	Di 226; 190 x 190; 4 x M8
CE.Z.ADAPT.SFG.MOT.195.CR	Di 175; BCD 195; 8 x M6
CE.Z.ADAPT.SFG.MOT.225.CR	Di 200; BCD 225; 8 x M6
CE.Z.ADAPT.SFG.MOT.260.CR	Di 240; BCD 260; 8 x M6
CE.Z.ADAPT.SFG.MOT.325.CR	Di 300; BCD 325; 8 x M6
CE.Z.ADAPT.SFG.NEW.265.CR	Di 240; BCD 265; 8 x M8
CE.Z.ADAPT.SFG.PI0.280.CR	Di 240; BCD 280; 4 x M8
CE.Z.ADAPT.SFG.PRO.245.CR	Di 208; BCD 245; 4 x M8
CE.Z.ADAPT.SFG.TSC.335.CR	Di 305; BCD 335; 4 x M6
CE.Z.ADAPT.SFG.WIT.354.CR	Di 300; BCD 354; 6 x M6

*other connection dimensions according to specifications

suction box (ASK.CE)

- stainless steel

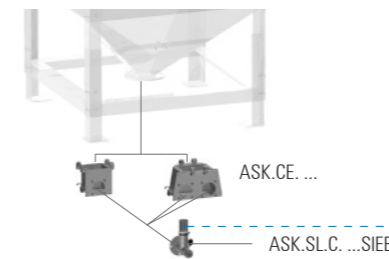

	number of suction points
ASK.CE.1	1
ASK.CE.2	2
ASK.CE.4	4

suction pipe for suction box

- stainless steel

	Ø
ASK.SL.C.038.SIEB	38
ASK.SL.C.040.SIEB	40
ASK.SL.C.045.SIEB	45
ASK.SL.C.050.SIEB	50
ASK.SL.C.060.SIEB	60
ASK.SL.C.065.SIEB	65
ASK.SL.C.070.SIEB	70
ASK.SL.C.076.SIEB	76

suction box (ASK.SL)

- stainless steel
- h1 of min. 400 mm required

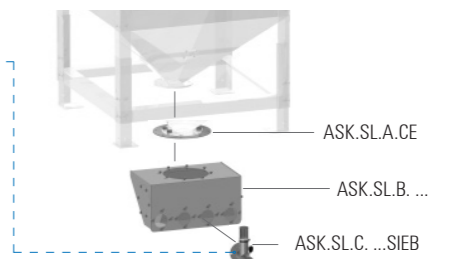

	number of suction points
ASK.SL.B.04	4
ASK.SL.B.06	6

swiveling arm

- stainless steel
- for total emptying

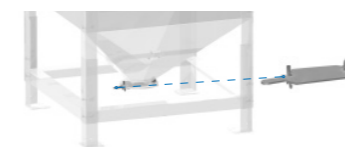

CE.Z.SCHWENK.100.CR

sleeve with plate

- stainless steel
- with plastic plug

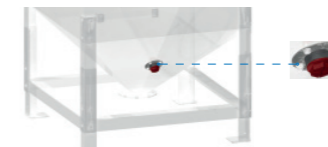

	size
CE.Z.GM.10.CR	1"
CE.Z.GM.15.CR	1 1/2"
CE.Z.GM.M30.1.5.CR	M30 x 1.5
CE.Z.GM.M32.1.5.CR	M32 x 1.5

roller

- 2 fixed rollers and 2 lockable guide rollers
- max. container size = 750 l



	h	material container
CE.Z.ROLLEN	155	stainless steel

warning lamp and level indicator

description		
CE.Z.LEUCHTE.01.230V	permanent warning lamp	230 V (50 Hz)
CE.Z.LEUCHTE.01.024V	permanent warning lamp	24 V DC
CE.Z.LEUCHTE.02.230V	flash lamp	230 V (50 Hz)
CE.Z.LEUCHTE.02.024V	flash lamp	24 V DC

description		
FÜ.MIN.4020.0170.01	level indicator	24V (DC) + 230 V (50Hz)

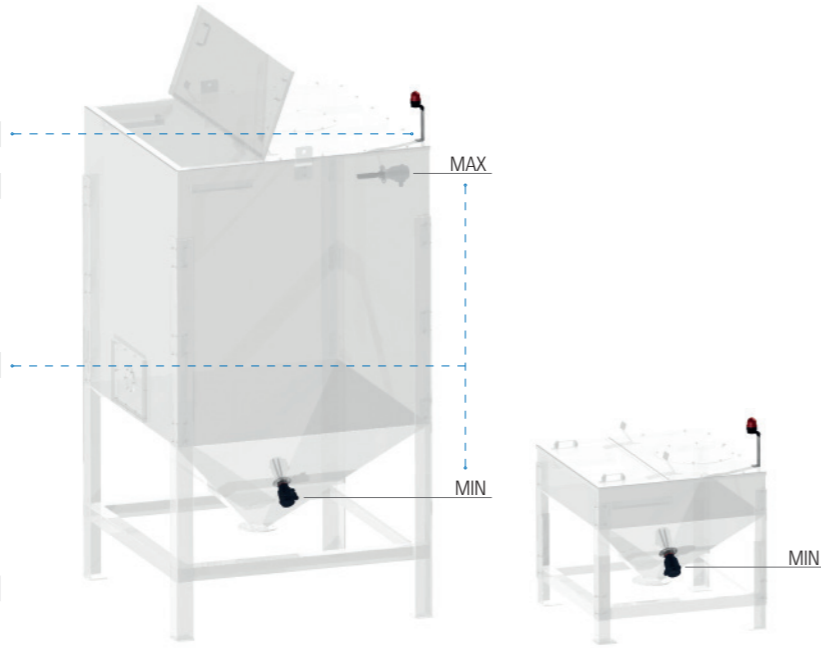

cabling ex works

description	
CE.Z.VVK.1.1	cabling „1 level indicator + 1 lamp“
CE.Z.VVK.2.1	cabling „2 level indicator + 1 lamp“

weighing system for container

- 4 weighing modules with load cells, terminal box and weighing terminal with display
- output RS232 for printer or remote indication

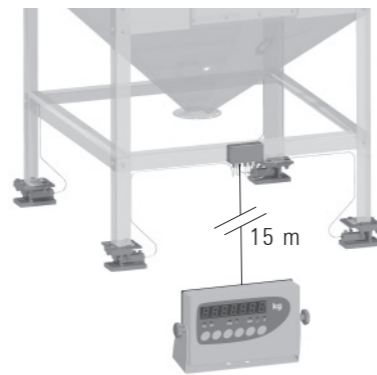

	nominal load (kg)	analog output	4 digital in-/ output
FÜ.WS.CE.01300.01	1300	no	no
FÜ.WS.CE.01300.11	1300	yes	yes
FÜ.WS.CE.05000.01	5000	no	no
FÜ.WS.CE.05000.11	5000	yes	yes

cover interlock (electro-mechanical guard locking)

- safety limit switch with plug connector, cable and small parts

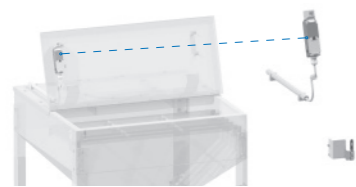

CE.Z.VERRIEGELUNG.01	24 V (DC)
----------------------	-----------

emergency slide valve

- stainless steel

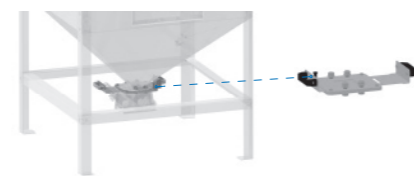

CE.Z.SCH.100.01

forklift skid set

- steel (RAL9005)

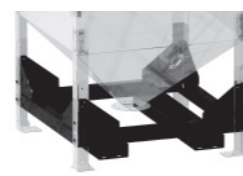

	container size	
	□	volume
CE.Z.KUFEN.1000.VAR.9005	1000	400/500 l
CE.Z.KUFEN.1200.FEST.9005	1200	1000/1500/2000 l
CE.Z.KUFEN.1200.VAR.9005	1200	500/750 l
CE.Z.KUFEN.1500.FEST.9005	1500	2000/2500/3000 l

stackable container CE.S1

stackable container CE.S1

- container made of aluminium
- 4 steel feet (RAL9005)
- foldaway cover with stop
- support for bar grate (bar grate optional)
- hole for vacuum conveyor on the roof (closed with plate)
- hole for level indicator in the cone (closed with plate)
- two guide tubes for suction probes Ø90 x 2.5 mm
- swiveling arm at the outlet for total emptying

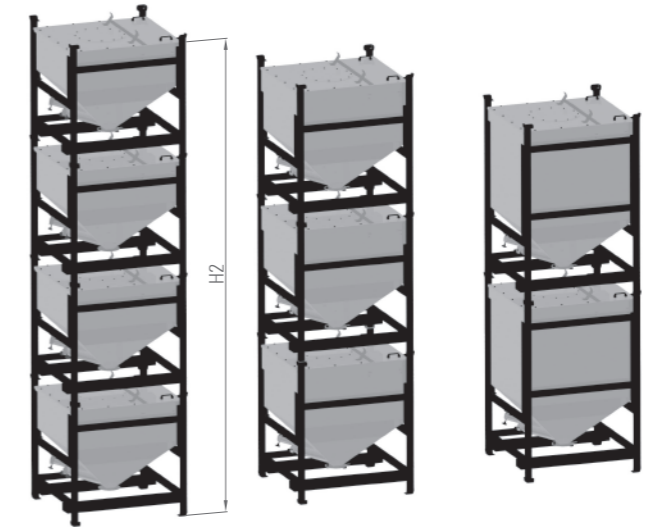
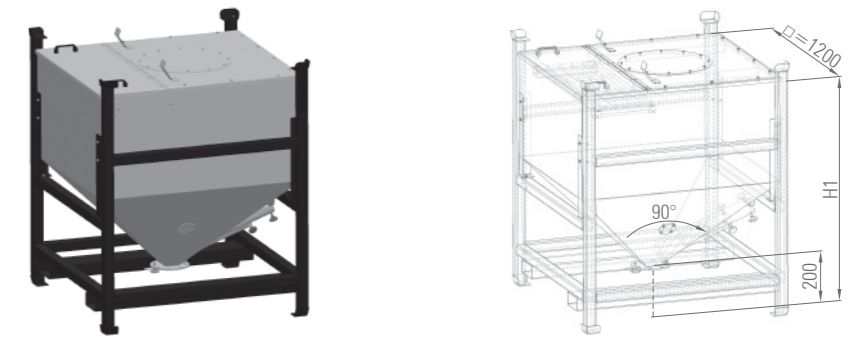

	H1	H2	volume	tare weight (kg)	contents (kg)	maximum weight (kg)	max. number of containers stacked
CE.S1.0750.1200.1200.90.01.AL	1240	4960	750 l	190	450	1920	4
CE.S1.1000.1200.1200.90.01.AL	1440	4320	1000 l	200	600	1600	3
CE.S1.1500.1200.1200.90.01.AL	1840	3680	1500 l	250	900	1150	2

inlet collar with cover

- inlet collar made of stainless steel
- cover made of plastics (transparent)

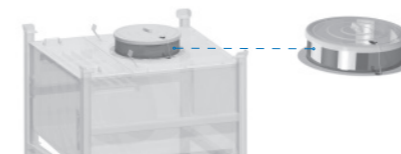

CE.S1.Z.INLET.450.01

grid

- stainless steel



CE.Z.ROST.1000.CR

butterfly valve ND100

- aluminium / stainless steel
- operation: manual

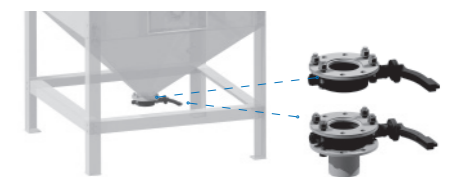

	with outlet pipe
CE.Z.DK.100.HH.OROHR	no
CE.Z.DK.100.HH.MROHR	yes

samples

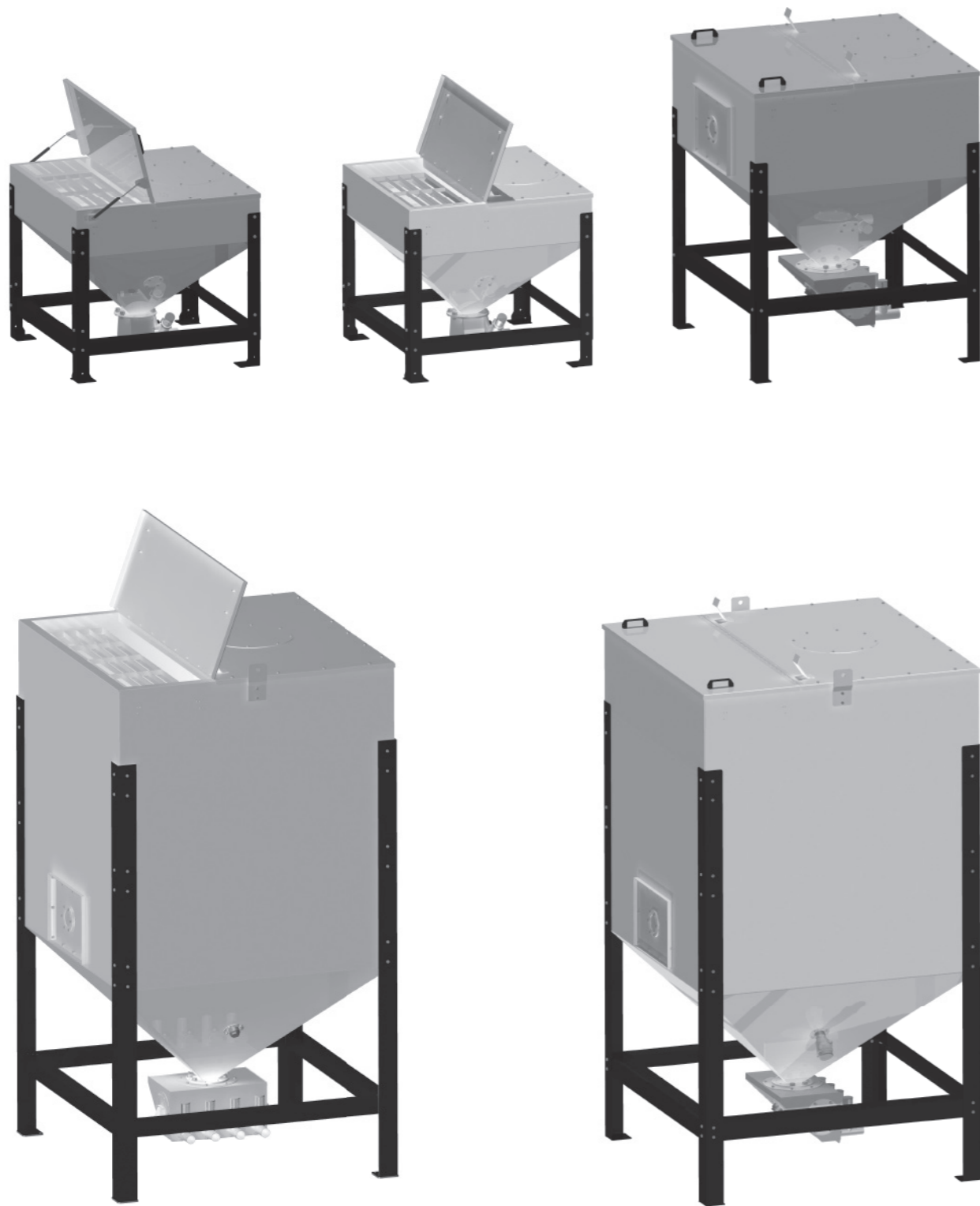

special constructions

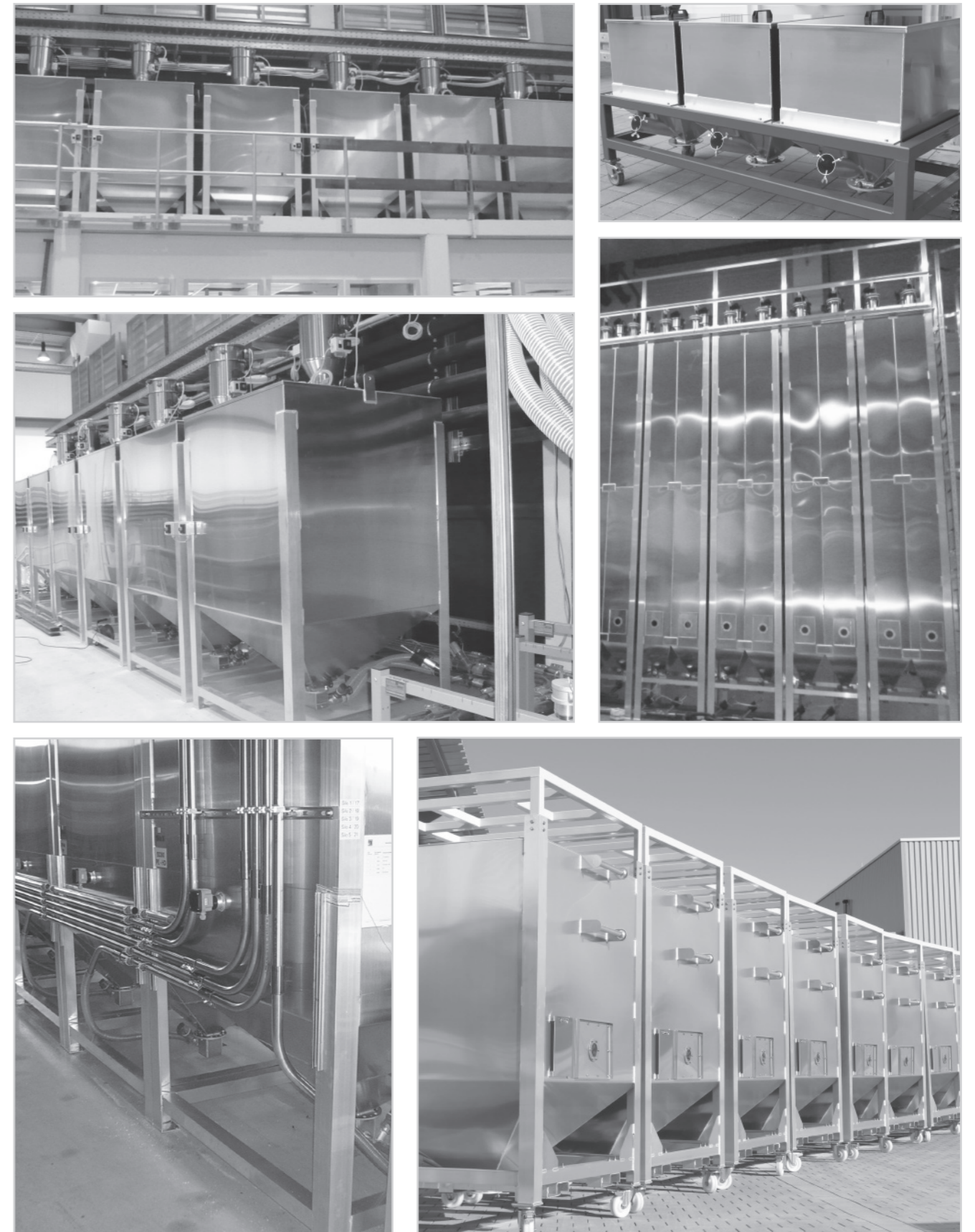

FIT SECM
7 Cours de Verdun
01105 Oyonnax
France

 +33 4 7477 6451

 +33 4 7473 8931

commercial@fit-oyonnax.com
www.fit-oyonnax.com